



7 Imber House, Millway Road, Andover, SP10 3LZ
Guide Price £175,000



7 Imber House, Millway Road Andover, Guide Price £175,000

PROPERTY DESCRIPTION BY Mr Ross Beeden

Graham & Co are delighted to offer this two bedroom top floor luxury apartment situated within walking distance of the train station and offered for sale with no onward chain. The accommodation comprises living room, kitchen, large walk-in store room, two bedrooms, and allocated parking as well as two further visitors parking spaces.





Full Description
A two bedroom top floor flat





APPROXIMATE GROSS INTERNAL AREA = 647 SQ FT / 60.1 SQ M

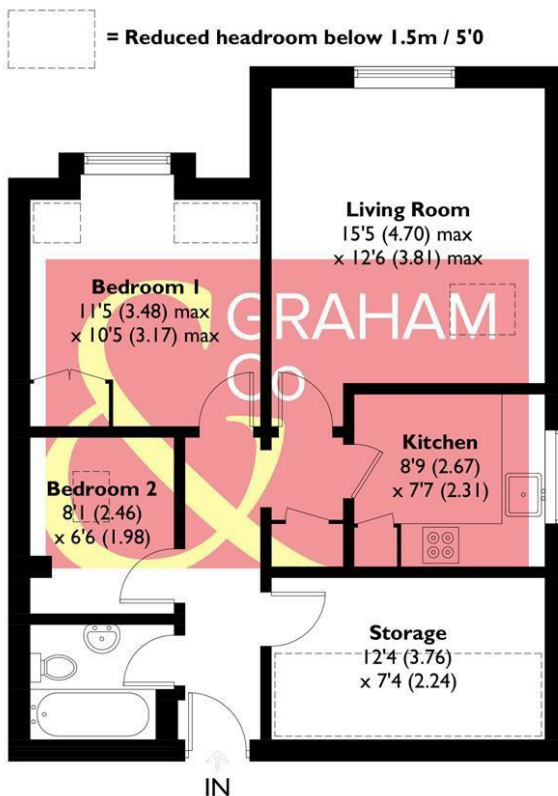

SECOND FLOOR

This plan is for layout guidance only. Not drawn to scale unless stated. Windows and door openings are approximate. Whilst every care is taken in the preparation of this plan, please check all dimensions, shapes and compass bearings before making any decisions reliant upon them. Created by Emzo Marketing (ID1294705)
Produced for Graham & Co

MORTGAGE ADVICE Across The Market Mortgages

An independent Mortgage brokerage offering expert advice from across the whole market. Whether you are a first-time buyer, home mover, remortgaging or buying a Buy-To-Let investment. Tristan can provide expert & reliable advice, in a clear jargon free language. Book a free consultation today.

E - tristan@atmmortgages.com M - 07545320380 www.atmmortgages.com

Energy Efficiency Rating		Current	Potential
Very energy efficient - lower running costs			
(95-100)	A		
(81-94)	B		
(69-80)	C		
(55-68)	D	62	64
(39-54)	E		
(21-38)	F		
(1-20)	G		
Not energy efficient - higher running costs			
England & Wales		EU Directive 2002/91/EC	

Tax Band: A



OPEN 7 DAYS

If you are considering selling your home please contact us today for your free no obligation valuation

01264 356500

IMPORTANT: we would like to inform prospective purchasers that these sales particulars have been prepared as a general guide only. A detailed survey has not been carried out, nor the services, appliances and fittings tested. Room sizes should not be relied upon for furnishing purposes and are approximate. If floor plans are included, they are for guidance only and illustration purposes only and may not be to scale. If there are any important matters likely to affect your decision to buy, please contact us before viewing the property.

