

11 Lillywhite Crescent, Andover, SP10 5NA
£1,650 Per Month

PROPERTY DESCRIPTION BY *Tanya Owens*

THIS IS LET AGREED AND NO LONGER AVAILABLE!!!

Graham & Co are delighted to bring to the market this spacious four bedroom detached family home positioned to the north side of the town. The property itself benefits from an entrance hall with cloakroom, living room leading to dining room then onto conservatory, kitchen/breakfast room. To the first floor there are four bedrooms with the master having en-suite shower room and family bathroom, gas central heating and double glazing. Outside a driveway leads to the double garage with enclosed garden to rear.

Unfurnished.

Available beg - mid Feb.

Pets considered.

Lillywhite Crescent, SP10

Approximate Gross Internal Area = 126.5 sq m / 1362 sq ft
Garage = 27.0 sq m / 291 sq ft
Total = 153.5 sq m / 1653 sq ft

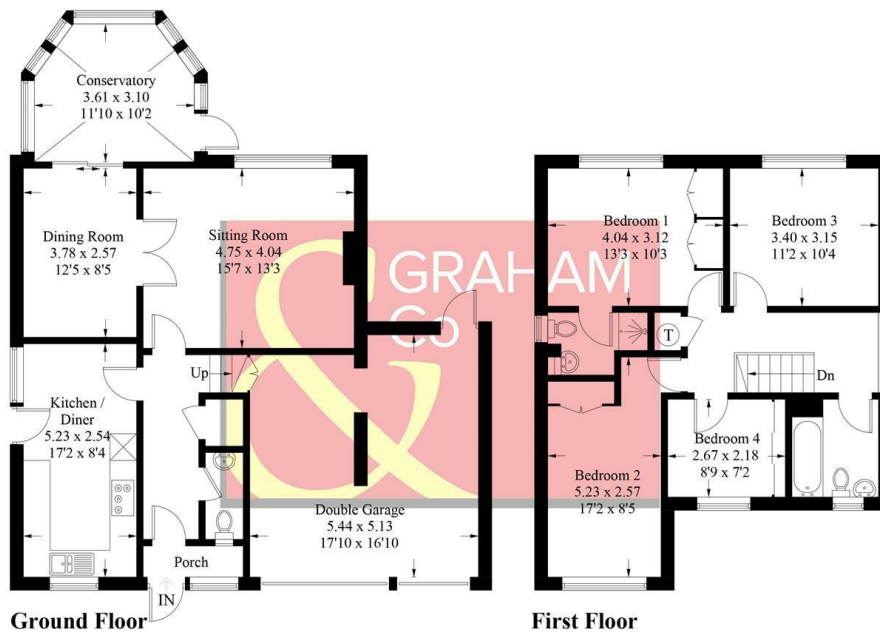

Ground Floor

First Floor

PRODUCED FOR GRAHAM AND CO

Whilst every attempt has been made to ensure the accuracy of the floorplan, measurements of doors, windows and rooms are approximate. These plans are for representation purposes only as defined by RICS Code of Measuring Practice and used as such by any prospective purchaser. © Emzo Marketing (ID891952)

DIRECTIONS

Leave Andover on the A343 Newbury Road. Proceed under the railway bridge and proceed straight across the next three roundabouts. Take the next turning right and take the second turning on the right into Lillywhite Crescent.

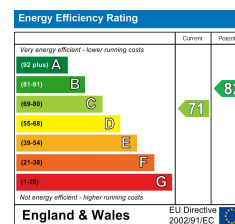

Tax Band: E



OPEN 7 DAYS

If you are considering selling your home please contact us today for your free no obligation valuation

01264 356500

IMPORTANT: we would like to inform prospective purchasers that these sales particulars have been prepared as a general guide only. A detailed survey has not been carried out, nor the services, appliances and fittings tested. Room sizes should not be relied upon for furnishing purposes and are approximate. If floor plans are included, they are for guidance only and illustration purposes only and may not be to scale. If there are any important matters likely to affect your decision to buy, please contact us before viewing the property.