



14a Colenzo Drive, Andover, SP10 1JN
Guide Price £165,000



14a Colenzo Drive, Andover,
Guide Price £165,000

PROPERTY DESCRIPTION BY Mr Ben Cox

Graham & Co are delighted to bring to the market this two bedroom ground floor apartment. The maisonette itself is situated in a sought after location and benefits from an entrance hall leading to living room with views to front, kitchen, two double bedroom and bathroom, gas central heating, double glazing. Outside there are front and rear gardens and a garage situated close to the property.





Andover offers a good range of shopping and recreational facilities including a theatre, cinema, new leisure centre, excellent selection of schools and a college for higher education. An abundance of open space and land with a selection of local nature reserve's all within walking distance of the town centre. The town itself boast a lovely "market town" feel and everything you may need is close at hand. The mainline train station offers a fast service to London Waterloo in just over an hour, and the A303 gives access to London via the M3 and the West Country.



Colenzo Drive, SP10

Approximate Gross Internal Area = 56.2 sq m / 605 sq ft

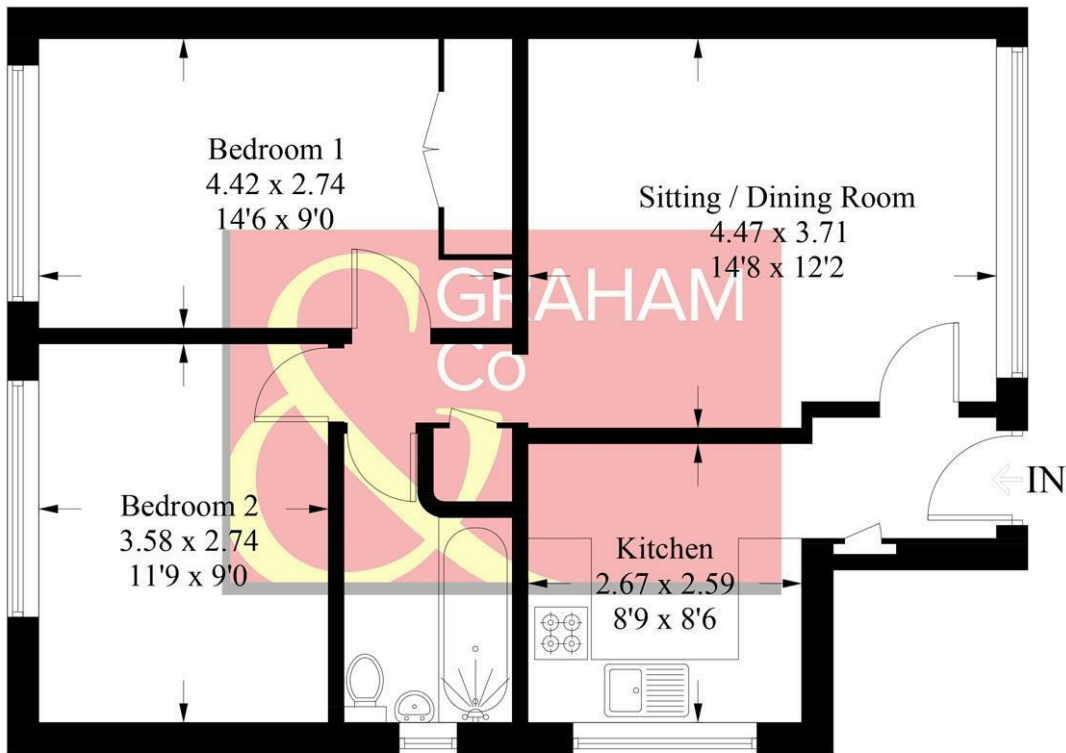

Ground Floor

PRODUCED FOR GRAHAM AND CO

Whilst every attempt has been made to ensure the accuracy of the floorplan, measurements of doors, windows and rooms are approximate. These plans are for representation purposes only as defined by RICS Code of Measuring Practice and used as such by any prospective purchaser. © Emzo Marketing (ID713859)

DIRECTIONS

From our office in London Street proceed to the roundabout and take the first exit left. At the next roundabout take the third exit into Vigo Road and take the second turning left into Colenzo Drive.

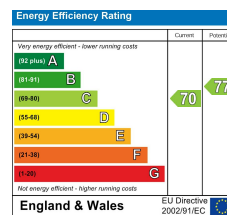

Tax Band: B



OPEN 7 DAYS

If you are considering selling your home please contact us today for your free no obligation valuation

01264 356500

IMPORTANT: we would like to inform prospective purchasers that these sales particulars have been prepared as a general guide only. A detailed survey has not been carried out, nor the services, appliances and fittings tested. Room sizes should not be relied upon for furnishing purposes and are approximate. If floor plans are included, they are for guidance only and illustration purposes only and may not be to scale. If there are any important matters likely to affect your decision to buy, please contact us before viewing the property.