



2 Spindle Close, Andover, SP11 6UR
Guide price £285,000



2 Spindle Close, Andover, Guide price £285,000

PROPERTY DESCRIPTION BY Mr Guy Sommerville

This nearly new three bedroom semi detached town house is well positioned on a popular modern development, situated on the outskirts of Andover and benefits from the remaining NHBC warranty. The well appointed accommodation in brief comprises; entrance hall, fitted kitchen, downstairs cloakroom, sitting room, two first floor bedrooms, family bathroom, second floor master bedroom with en-suite shower room, landscaped rear garden and two allocated side by side parking spaces.





Augusta Park has history woven into its fabric with old flint farm walls from East Anton's time as farmland forming part of a major regeneration programme to this already well-established and bustling Hampshire town. This is an area with its own rich history. Andover is the location of a major crossing point of two important Roman roads: the Portway from Winchester to Marlborough, and the Icknield Way, which runs past Augusta Park on its way between Salisbury and Silchester. The actual site of the crossroads is very close to the development, but excavations in 1970, while revealing many Roman remains, failed to find the exact location. Now the area is a growing and welcoming community with a community centre, sports pavilion and the Endeavour Primary School already open, together with planned shops and village 'local area'. You will feel you belong from the start in a home tailored to modern living set amongst acres of beautifully landscaped open spaces, parks and play areas. Not wanting to travel too far for groceries? Then the brand new Co-op opened in April 2018 is on the doorstep located in East Anton Farm Road, along with the recently opened pizza takeaway for those not wanting to cook. Please note that as with most modern housing developments, this property may have a minimal yearly "estate charge". Please ask for further information.



Andover, SP11

Approximate Gross Internal Area = 113.1 sq m / 1217 sq ft

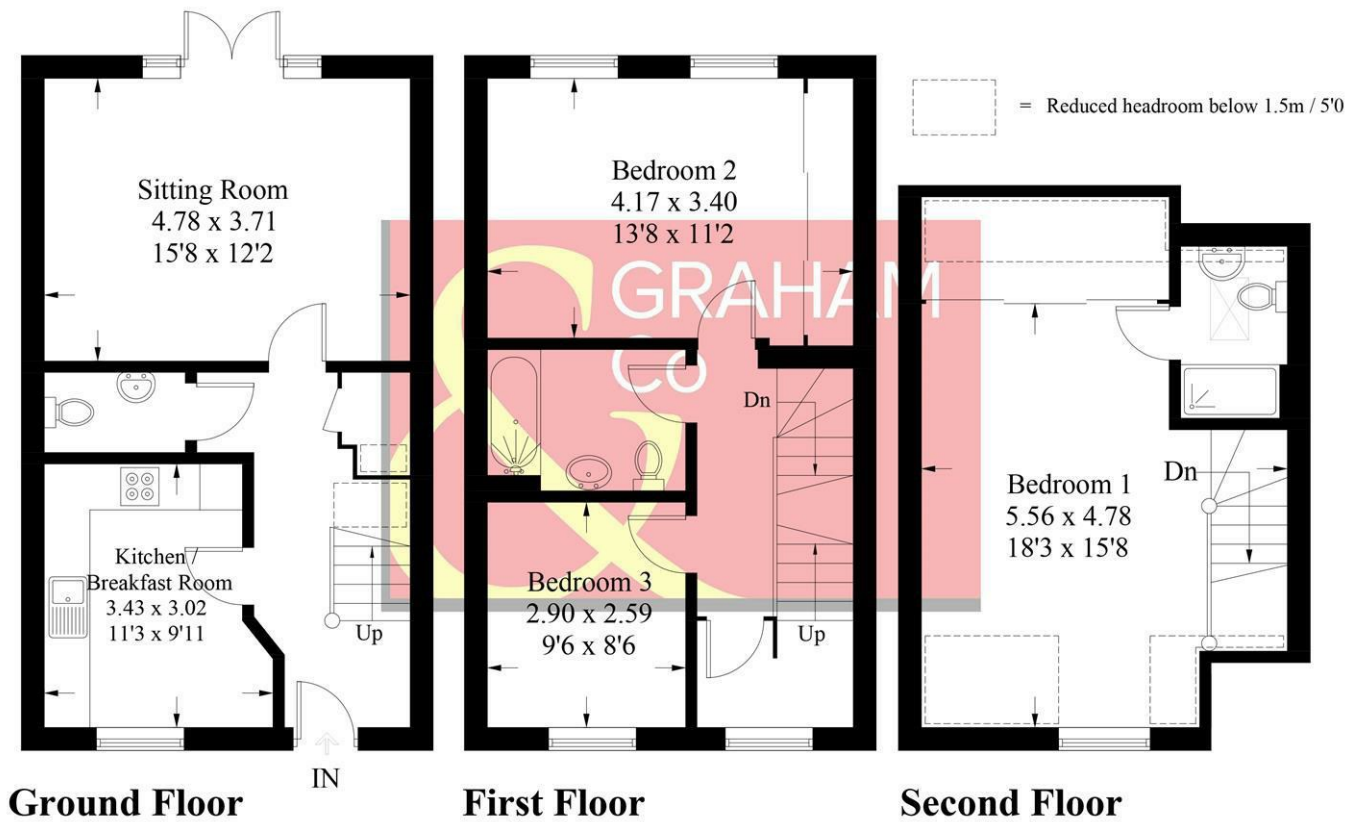

PRODUCED FOR GRAHAM AND CO

Whilst every attempt has been made to ensure the accuracy of the floorplan, measurements of doors, windows and rooms are approximate. These plans are for representation purposes only as defined by RICS Code of Measuring Practice and used as such by any prospective purchaser. © Emzo Marketing (ID624067)

DIRECTIONS

From our office in London Street proceed to the roundabout and take the 1st exit into Eastern Avenue. At the roundabout take the 2nd exit into New St. Continue along to the roundabout and take the 2nd exit. At the roundabout take the 3rd exit into Newbury Road, passing the traffic lights and under Enham Arch. At the next roundabout take the 2nd exit right into Smannell Road. At the 3rd roundabout take the 2nd exit and continue to the top and turn left into Fuller Way. Follow the road straight on until you reach the T-junction, then turn left, here Spindle Close can be found on the right hand side.

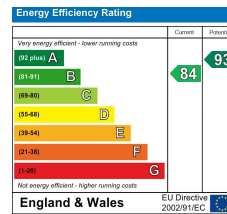

Tax Band: D



OPEN 7 DAYS

If you are considering selling your home please contact us today for your free no obligation valuation

01264 356500

IMPORTANT: We would like to inform prospective purchasers that these sales particulars have been prepared as a general guide only. A detailed survey has not been carried out, nor the services, appliances and fittings tested. Room sizes should not be relied upon for furnishing purposes and are approximate. If floor plans are included, they are for guidance only and illustration purposes only and may not be to scale. If there are any important matters likely to affect your decision to buy, please contact us before viewing the property.