



7 Adams Road, Picket Piece, Andover, SP11 6UY
Asking Price £199,950



7 Adams Road, Picket Piece Andover,
Asking Price £199,950

PROPERTY DESCRIPTION BY Mr Ross Beeden

Positioned on the sought-after development in Picket Piece on the outskirts of Andover Town with countryside surround, Graham & Co are delighted to offer for sale this immaculately presented two-bedroom coach house. The property itself benefits from an entrance hall leading to first floor, open plan living space with living room, dining area and a fully fitted kitchen to include built in hob, oven and extractor and dishwasher. There are two double bedrooms with the master having en-suite shower room and a separate bathroom, gas central heating and double glazing. Outside a carport provides parking, storage and further storage cupboard, further parking. Internal viewing is imperative for the property to be fully appreciated.





Locksbridge Park

Close enough to the town to be convenient, yet just far enough into the countryside to be away from the hustle and bustle, Locksbridge Park is a well-planned and designed new development built by Messer's David Wilson and Barratt homes. Just over a mile to the East of Andover is where you will find this development including a good mixture of property, ideally located close to the bustling town of Andover. Andover has enjoyed something of a renaissance in recent years four hundred years after its stagecoach origins, it is far from being just a commuter town. Andover is now considered by many to be a destination in its own right. The town now benefits from an eclectic mix of old-world charm and modern shopping convenience, as well as beautiful tea rooms and pubs, some dating back more than nine hundred years, supermarkets, craft galleries and interior design stores, which all border the breath-taking countryside of the Test Valley - 250 square miles of easily accessible natural beauty, which includes the world-renowned River Test. Please note that as with most modern housing developments, this property may have a minimal yearly "estate charge". Please ask for further information.



Adams Road, Picket Piece, Andover, SP11

Approximate Gross Internal Area = 65.5 sq m / 705 sq ft
(Excluding Carport)



 = Reduced headroom below 1.5m / 5'0

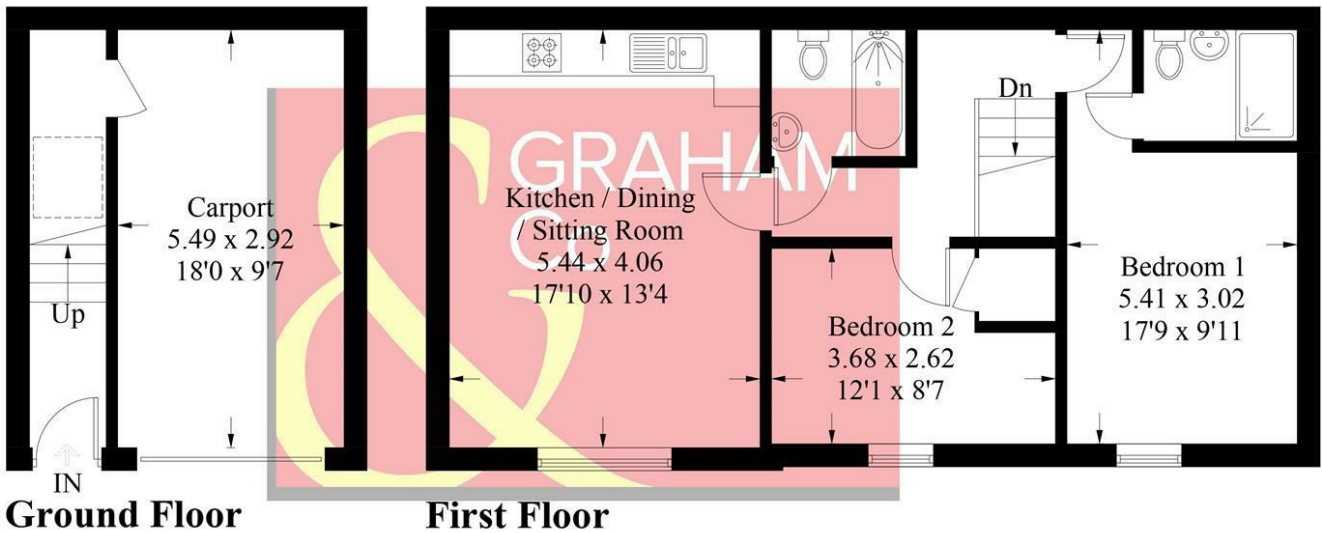

PRODUCED FOR GRAHAM AND CO

Whilst every attempt has been made to ensure the accuracy of the floorplan, measurements of doors, windows and rooms are approximate. These plans are for representation purposes only as defined by RICS Code of Measuring Practice and used as such by any prospective purchaser. © Emzo Marketing (ID610008)

DIRECTIONS

From our office in London Street proceed to the roundabout and take the first exit. Take the second turning on the right into London Road and proceed to the Walworth roundabout. Take the second exit left into Walworth Road and proceed into the village of Picket Piece, where the development 'Locksbridge Park' can be found on the right-hand side. Turn right into Locksbridge Road and take the first turning right into Kings Chapel Road. Follow the road around to the left where Adams Road can be found on the right-hand side.

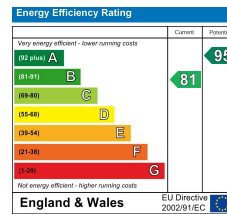

Tax Band: B



OPEN 7 DAYS

If you are considering selling your home please contact us today for your free no obligation valuation

01264 356500

IMPORTANT: we would like to inform prospective purchasers that these sales particulars have been prepared as a general guide only. A detailed survey has not been carried out, nor the services, appliances and fittings tested. Room sizes should not be relied upon for furnishing purposes and are approximate. If floor plans are included, they are for guidance only and illustration purposes only and may not be to scale. If there are any important matters likely to affect your decision to buy, please contact us before viewing the property.